

Aroma Diffuser

User Manual (APP version)

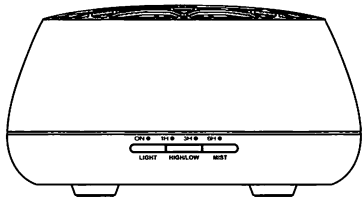

PRODUCT DESCRIPTIONS

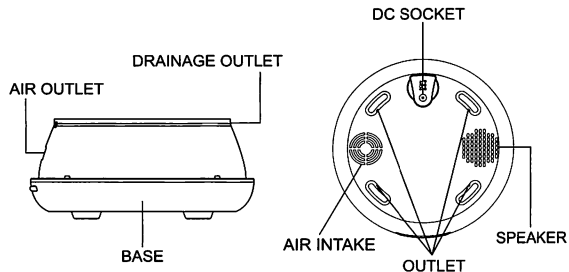
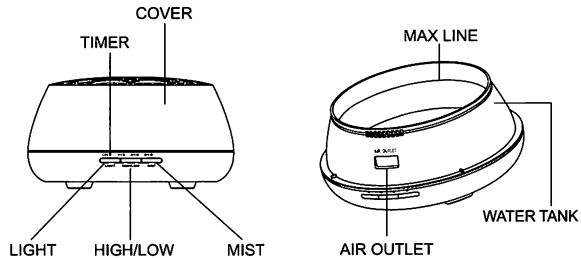

TROUBLESHOOTING

Please refer to the sheet below when the unit fails to work.	
Fail to turn on the unit	<ul style="list-style-type: none"> Is there enough water in the tank? --Add water to the tank. Is the power cord connected properly? --Disconnected, check cables and re-connect carefully. Does water amount exceed the MAX line? --Reduce the water amount and make sure it is below MAX line.
Turn off suddenly when it works	<ul style="list-style-type: none"> Does water amount exceed the MAX line? --Reduce the water amount and make sure it is below MAX line.
No mist or abnormal mist	<ul style="list-style-type: none"> Not enough water or too much water? --Add water to the tank but not fill over 400ML MAX line. Dirt on the ultrasonic atomizer? --Please refer to maintenance instructions to clean the unit. Too much dirt on the air intake? --Please use the brush to clean the air intake part.
Water leakage from product	<ul style="list-style-type: none"> Low temperature or high humidity? --Under these conditions, the mist may condense quickly into water droplets. Please wipe them up.

SPECIFICATIONS

Size:	178*178*97mm
Weight:	Approx 413g
Power: input/output	AC100-240V 50/60HZ / DC 24V 500MA
Cable length:	Approx 150cm
Electric consumption:	Approx 7W
Timer	ON/1H/3H/6H/Customize
Mist mode:	High mist mode/ Low mist mode/ Intermittent mist mode
Water capacity:	400ML
Material:	PP / ABS
Accessories:	The adaptor, User manual
Ultrasonic vibration:	2.4MHz

OPERATION

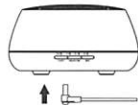

- 1 Connect the DC port to the DC slot of the base.



- 2 Take off the cover.

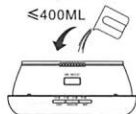

- 3 Add water into the tank, don't exceed the max 400ML.



- 4 Add some essential oils into the water(2-3 drops per 100ML)



- 5 Re-install the cover.

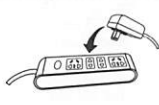

- 6 Connect the AC adaptor to the power socket.

7 MIST:

First press, it enters into high mist mode with "ON" continuous mist option.
Keep pressing to move to 1H/3H/6H/OFF.
Long press 2s can turn off the unit at any mode.

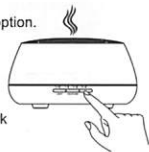

8 HIGH/LOW:

First press, the unit enters into low mist mode with sound of "DD"
Second press to enter into intermittent mist with sound of "DDD"(work 30s, stop 30s, recycle).
Third press, high mist with sound of "D"

9 LIGHT:

First press, 7 LED colors changing automatically. Second press, pause on current color.
Third press, move to next color and each color is adjustable between bright and dim mode.
When power connects, LIGHT can work alone.

GUIDANCE ON APP CONNECTION

- Please scan the provided QR Code on the manual, then install the APP as per instructions.
- Turn on Bluetooth, connect "Aromamusic" device. Then music can be played.

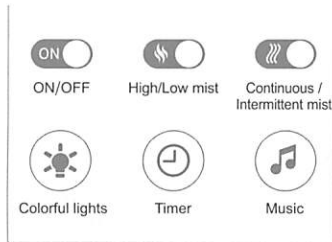

	High/Low mist
	Continuous / Intermittent mist mode(Work 30s, stop 30s, recycle)
	color fix mode/ color auto change mode
	Timer setting: 1H /3H/6H/Customize
	Music player

Note: IOS system version must be 9.0 or above.
Android system version must be 4.3 or above.

QR Code

Scan to download app.



IOS



Android

WARM TIPS

- Please use other container to add water. Don't fill in the tank from water-tap directly.
- Pure essential oils or oils which can be soluble into water are available for use. Please clean the unit as per the maintenance instructions before changing a new type of essential oil.
- It is quite normal that different humidity environment and temperature will affect the mist density.
- Do not let the mist spray to the furniture, clothes, wall directly.
- The essential oils may cause dye. Please use clean cloth wipe up if splashed out accidentally.
- To ensure the sanitation, please pour out the water completely and wipe up the unit with soft cloth after each use.
- If you don't use the unit for a long time, please pour out any remaining water completely in the tank and store it at dry place.
- When the power connects, the unit original state is OFF.
- If there is short of water in the tank, even though the power connects, the unit will shut automatically. Meanwhile, all functions will be off.

MAINTENANCE

After using 5-6times or 3-5days, please clean the product as follows:

1. Turn off the power and disconnect the DC adaptor.
2. Pour out any remaining water completely in the tank. Do not pour out water from the air outlet side. (Fig.1)
3. Put a small amount of detergent diluted in the water. Then use a clean cloth dip in the water and wipe up the unit gently. If there is any dirt in the inner side of tank, please clean it.
4. Never use medical diluent, alcohol during maintenance. Or it may cause product damage and erase various signs on the product.

Note: please use neutral detergents.

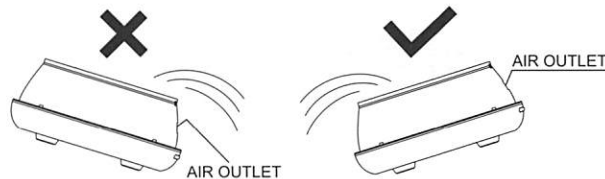

(Fig.1)

PRECAUTIONS

Please read carefully the following safety precautions before using this unit. The safety precautions listed below are intended to prevent you and others from injury or to prevent damage to the product.

Warning: May cause serious personal injury.

- Please keep the unit unreachable for children and babies, winding around the power cord to the children's neck mistakenly may lead to suffocation death.
- Please use standard adaptor of this unit.
- Please don't dismantle, modify, heating the unit.
- Avoiding from falling down or heavily hitting.
- If the unit smoke, make a smell, or have any abnormal situation, please stop using it immediately.
- Do not touch any part of the unit with wet hands.
- Do not allow the metal objects (like pin, key) in contact with the terminals or plug.
- Do not cut, damage, modify the power cord or put the weight on the power cord. Otherwise it may cause an electric shock or fire.

Attentions: May cause product damaged.

- Do not allow liquids or foreign matter to enter the unit. Otherwise it may cause irreparable damage to the unit.
- Please unplug the unit when not use.
- Do not cover anything on the unit when it is working.
- Please placed the unit in a safe place where others will not be tripped by the power cord or it may cause injury or damage to the unit.
- Avoid using the unit at the following locations:
Direct sunlight, high temperature or wet, dusty place.
- Keep away from electronic equipment: such as TV, Audio equipment.
- Keep away from strong vibrating place.